

## Colonial Measuring Instructions

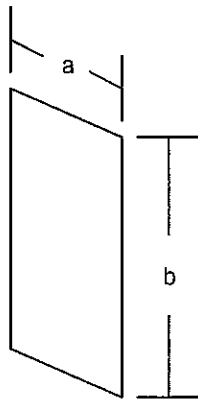

### Measuring Opening Without Projecting Sill

a = Opening width. Add 1" to width for actual shutter size

b = Opening height. Add 1" to height for actual shutter height.

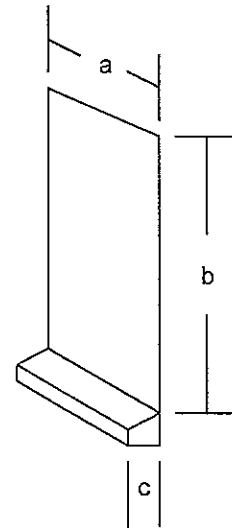

### Measuring Opening With Projecting Sill

a = Opening width. Add 1" to width for actual shutter width.

b = Opening height. Add ½" to height for actual shutter height.

The instructions above are a suggested method of measuring only. Construction methods differ from building to building. It is important to remember that hurricane shutters are specified to mount to something structural within the framework of the building. It is each dealer's responsibility to determine what the shutters will be attached to and whether or not the above suggested guidelines should be used for each opening being measured.

## Measuring



Colonial  
Shutters

Colonial style shutters have been used for as long as man could build them. They are installed on hinges at the side of openings and can be folded over the opening or stored to the side of each opening. The dimensions we need are the width of the opening and the height of the opening. Standard allowances will be made by us.

For example, should you require a surface mount, the following allowances would be made. To obtain the panel width, we divide the opening width by 2 and add 2". That means the panel coverage will be 4" greater than the opening width. The height of the panels will be 4" greater than the opening height. Except! If you have a window sill that extends out from the wall surface the panels will be 2" greater than the opening dimension and when the shutters are closed they will be above the existing sill.

If you require a recess mount, the panel coverage will be reduced overall by 1/2 inch in width and height. Keep in mind you will need space on each side of the window for the panels in the stored position.



Bahama  
Shutters

Bahama shutters are a great functional product that works for you full time providing sun, rain, light and privacy while looking great all at the same time.

Measuring is simple. The opening width and height is all we require. For a surface mount, we will add 4" to the width and 4" to the height of the opening you provide. Should you request a recess mount, we simply subtract 1/2 inch from both the width and the height of the opening. The exception is if you have a sill that extends out from the opening we add only 2" to the opening height

## General Guidelines for Installing Exterior Colonial Shutters & Bahama Shutters

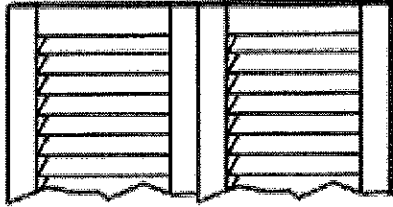

**Shutters in Closed Position**

**Colonial Shutters**

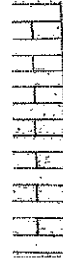

**Click to Enlarge**

### Bahama Shutters

- Installation instructions provided by the manufacturer.*
1. Leave the top hinge in the wall providing opening using approved fasteners (in the particular application) installed over the top hinge and level.
  2. Attach the shutter panel. Bahama Shutter are on the top panel of the panel directed into the frame opening in the shutter top edge (pointing in wall).
  3. Attach the bottom arm at the top of the sliding arm for the bottom panel its coded fastener located on the side of the panel with 1/8" x 20 phillips screw.
  4. Attach panel bracket into the wall approximately 1/2" away from the edge of the bottom panel at a location of your choice. (Optional: the panel bracket is drilled into with the bottom of the panel or as a lip. The lip on the panel is located in a hole, the fastener through the panel. Please note that you should not, in some cases, the arm will not, blocking the opening panel.
  5. Connect the lower section of the sliding arm into the panel to lock right the bottom bar.
  6. Turn the shutter to see if it is properly set on the sliding arm to make the proper angle or projection on the bottom shutter panel.

**Bahama Shutters**

To deflect rain away from the structure, louvered shutters should be installed so the louvers face AWAY from the structure when shutters are closed.

Click on images to enlarge.

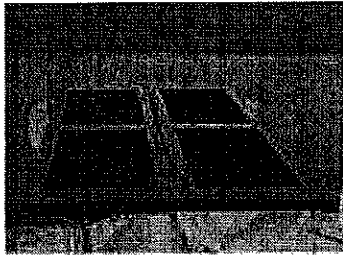

1. Pick shutters to fit window and put next to each window on top of saw horses to make sure shutters are paired properly. Lay two shutters face down next to each and prepare to install hinges.



2. Install hinges after determining offset. Hinges are to be set at top and bottom even with outside. Drill holes with 1/8th pilot bit. Be careful not to drill all the way through shutter.



3. Position and install upper holdback clips 1" from top and center edge of stile. Shutters over 58" require 2 sets of acorns; install similarly at top.

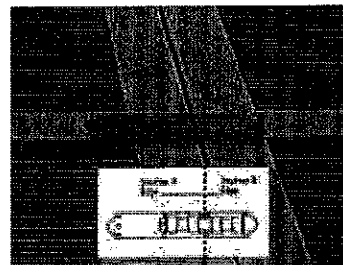

4. Install slide bolt - turn shutters over and line up slide bolt edge with shutter edge. Pre-drill 1/8 slot hole (careful not to drill all the way through). Install slide bolt with screws. Shutters are now ready for installation.



5. Position shutter in opening allowing equal amounts of space between shutter and wall (A & B), and between shutters (C) to allow for smooth operation. When attaching the pintel to the structure, you may have to drill into mortar and brick.



6. Install acorn (anchor). Swing shutter open and mark center of holdback slip and install acorn anchoring brick.

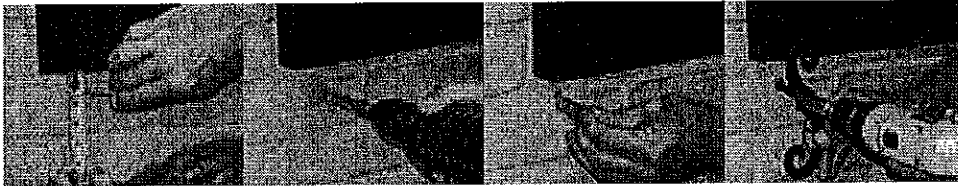

7. Install 'S' Holdback\*. Shutter is now held open by acorn anchor. Position shutter latch in correct location and mark for screws and fasten to wall, 1-1/2" sown from shutter and 1-3/4" from outside edge.

\*The acorn anchor is better suited for holding the shutters in place, and as such, the 'S' Holdback is recommended more for decorative use as opposed to a functional use.